



Positron XDC Overview

**Scalable Multi-Client, Multi-Transport
Data Transfers for Public Safety**

February 2004

Introduction

This document provides an overview of the functionality and architecture of Positron's XDC, a scalable multi-client, multi-transport data transfer system designed for the Public Safety environment.

Please note that due to product evolution, enclosed specifications are subject to change.

Traditional Data Transfer

A common feature found in many PSAP systems is the ability to transfer ALI or other information to remote printers and/or fax machines.

Remote Printers

A basic feature is the transmittal of ALI to a remote serial printer. Typically a Controller-resident feature, ALI data as received from the ALI Database is manually transmitted to a remote site's serial printer over either dedicated or dial-up PSTN links. A modem at the PSAP end sends to a modem / printer pair at a given receiving end.

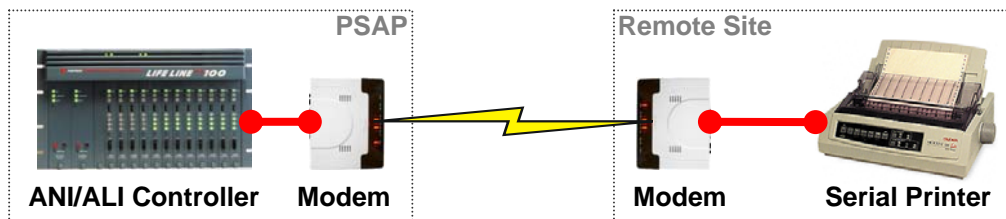

Remote Fax Machines

A more modern variant of the above is the transmittal of ALI and other information to remote sites equipped with receiving Fax machines. This is typically a PC-based feature brought on by the wider introduction of computers and fax/modem technology into the PSAP.

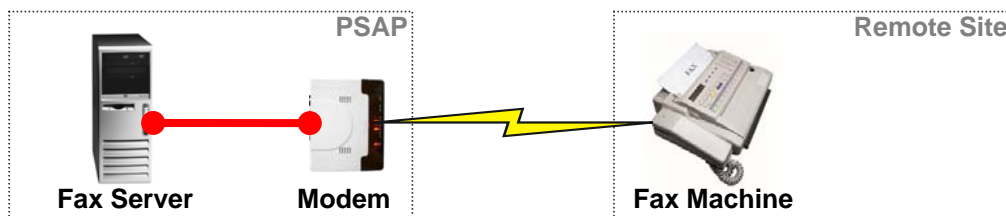

A New Age for Data Transfers

The traditional data transfer features meet basic needs, but Positron's End-to-End system approach (an entire integrated suite of PSAP applications such as emergency call handling, dispatch, mapping, radio and records management, from a single vendor), allows for more extensive data transfer functionality.

Positron XDC Basics

Positron's XDC (eXtended Data Communication) is a system for providing a wide range of data transfer capabilities to multiple applications within the PSAP or dispatch center.

Positron's XDC data transfer system is **Multi-Client**, providing data transfer capabilities to several of Positron's IWS suite of applications such as Power 911, Power MAP and Power CAD (more on these capabilities later in this document).

A **Client-Server Architecture** offloads transfer processing from the workstation computers, preventing any potential performance impact to call handling or dispatch operations at the positions. As the transfer request is handed-off for processing, the requesting application is free to perform other tasks.

Positron XDC is **Highly Scalable**. The XDC architecture allows for multiple servers, each configured to specialize in one or more of the many transport methods. Servers can be grouped by capability (and even belong to multiple groups) for absolute flexibility and optimized use of server resources, an approach that supports even the most demanding data transfer workloads.

Positron XDC provides **Multiple Transport** mechanisms for getting your information to the right place...

Transport	Content	Destination
Fax	Text and Image Data	Printed by receiving Fax Machine or captured / stored / printed by Fax-enabled receiving computer
Alphanumeric Paging	Any alphanumeric sequence of characters	Text and numbers appear on Pager display
Numeric Paging	Any sequence of digits	Numbers appear on Pager display
E-Mail	Text and HTML as message body, any file type as an attachment	Message and attachments captured / stored / printed by E-Mail enabled receiving computer
FTP	Any file	Stored in specified remote directory
Print	Text and Image Data	Text and Images printed to WAN networked printer

Positron XDC with Power 911



When used with Power 911 (4.21 SP1 or higher), Positron XDC provides transmission of ANI / ALI / TTY conversations / Incident Location / Calling Party Information plus other call information, as well as information gathered via Power 911's Incident Management option. The information presented is completely customizable via RTF document templates that specify what information is included, its placement on the page or device, as well as boilerplate text and images such as logos (for devices that support graphics). You can also have different templates for different remote destinations.

Positron XDC with Power MAP



When used with Power MAP (3.0 SP1 or higher), Positron XDC provides fax or e-mail transmission of the map as it's seen on the Power MAP screen, including all icons and event details such as phone number, address, and comments field, date and time.

Positron XDC also allows Power MAP to print maps on remote networked printers.

Positron XDC with Power CAD



When used with Power CAD 2.3's Notification Server, Positron XDC provides template-based fax transmission of event notifications. The Notification Server also supports e-mail and pager (numeric and alpha) transmission of notifications.

XDC System Architecture

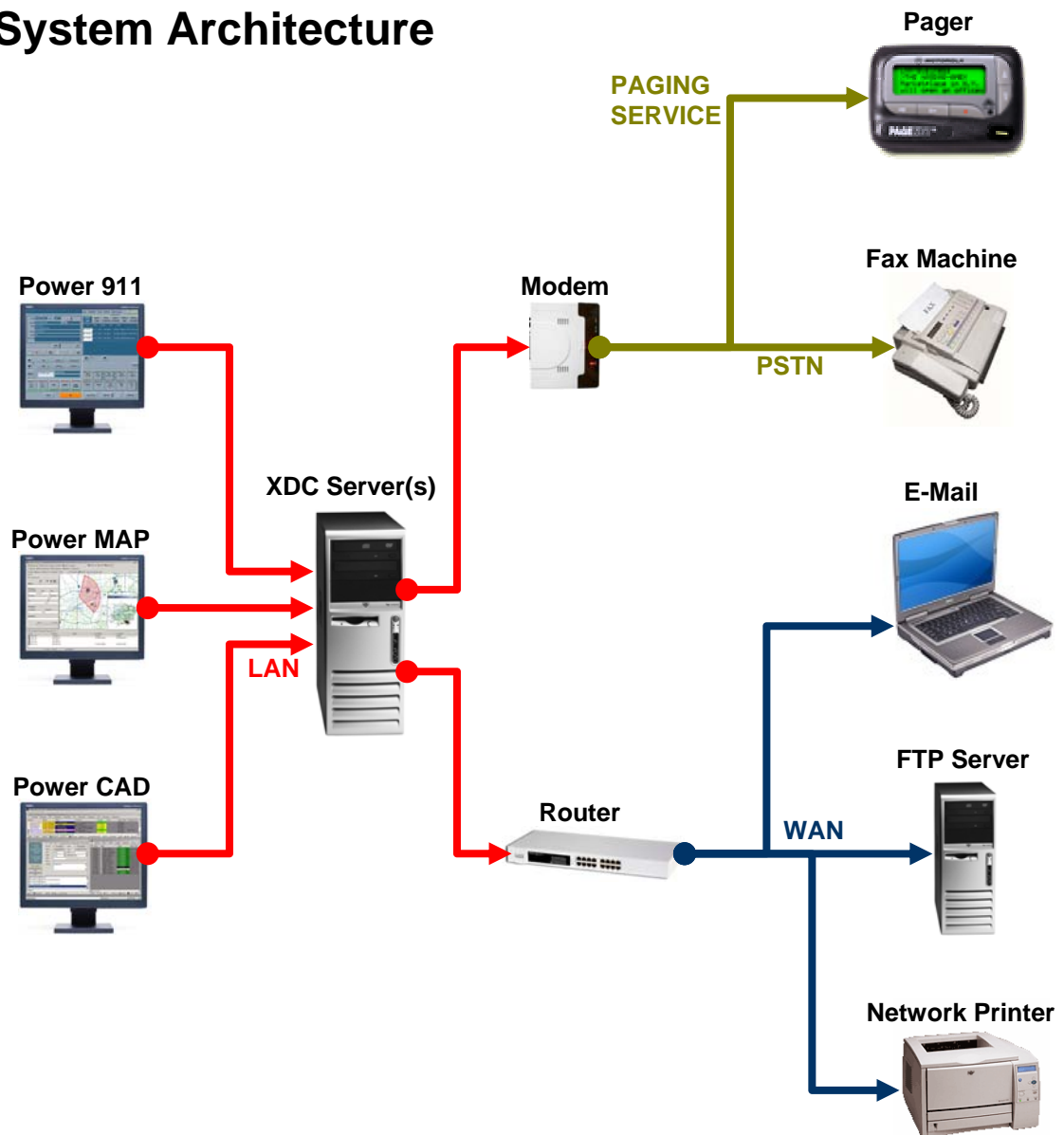

Getting More Information

To find out more about how **Positron XDC** can give you the Power to Respond, please contact:

- your Regional Sales Manager (www.positron911.com/corporate/contact)
- email info@positron911.com
- call 800-443-3313